



# PARK RESIDENCES

SM CITY STA. ROSA, LAGUNA

WINNER

BEST CONDO DEVELOPMENT (GREATER MANILA)

Park Residences by SM Development Corporation

2019



*A Picture Perfect Life*





### *A Picture Perfect Life*

Park Residences is the ideal place for you and your family to settle down. Bask in the warm ambiance of our verdant surroundings, calm your mind in the comfort of our stylish homes, and form memorable bonds with our fun, flourishing community. A picture perfect life awaits you at Park Residences.





	<b>SHOPPING MALLS</b>	
	SM City Sta. Rosa	± 0.20km
	Robinsons Mall Sta. Rosa	± 1km
	Pavillion Mall	± 2.2km
	Central Mall	± 3km
	<b>TRANSPORTATION HUBS</b>	
	Balibago Transport Terminal	± 1.9km
	<b>SCHOOLS</b>	
	Brent International School	± 1.7km
	<b>ENTERTAINMENT</b>	
	Enchanted Kingdom	± 3.08km
	<b>RECREATIONAL</b>	
	Olivarez Plaza	± 3.2km
	Nuvali	± 8.5km
	Paseo de Sta. Rosa	± 7km
	Tagaytay City	± 25km



### A Picture of Convenience

Park Residences lies within the growing city of Sta. Rosa, Laguna. Located just across SM City Sta. Rosa, with schools, parks, and shops around every corner, find all you need and live your best life here!

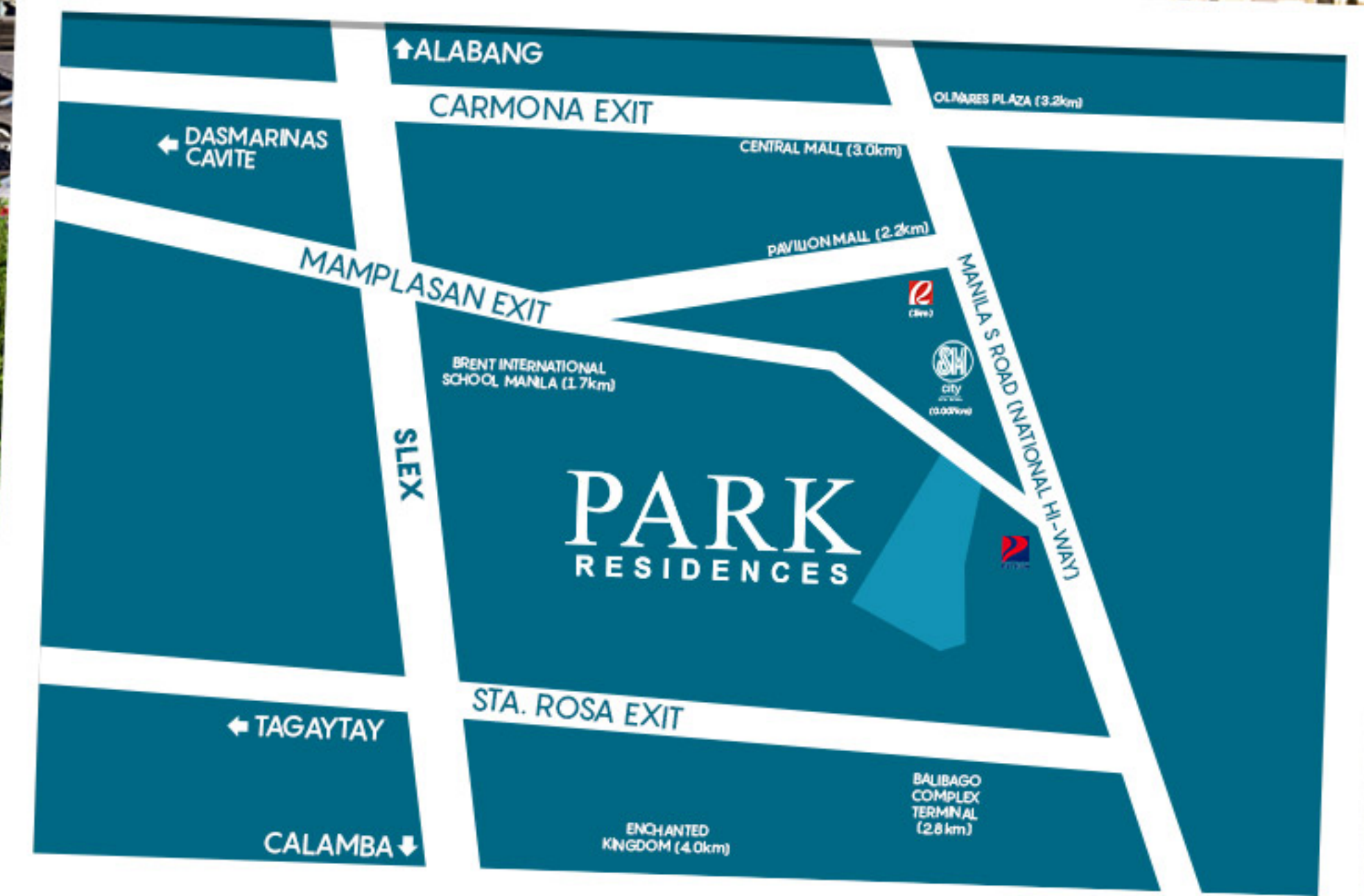

Vicinity Map





### *A Picture of Pleasure*

Whatever you're looking for – be it retail therapy, wellness services, entertainment options or a variety of dining spots – find it just a few steps away from your home at SM City Sta. Rosa. Living has never been this easy!





Happy Day



Shops



Grocery



Movie House



Restaurants



Arcade



Department Store

*A Picture of Fun*  
Enjoy all the perks of having a home beside the mall. See a movie, do your groceries, shop, play, eat, and do it all just a few steps away from your front door!

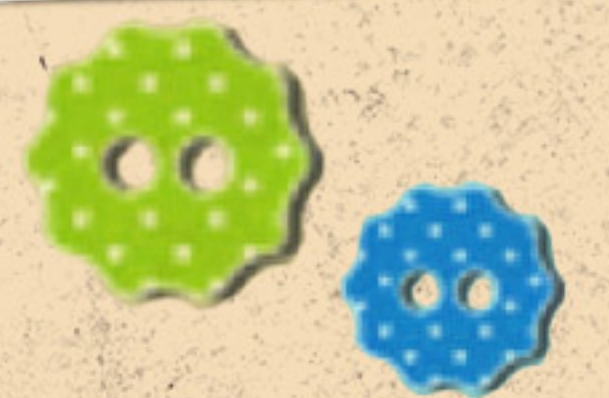



## A Picture of Harmony



Let the kids have fun at our Active Zone, reflect with some spiritual meditation at the Tranquil Zone, take a walk with your significant other at our Social Zone, and come together at the heart of our beautiful, luxuriant Central Park. At Park Residences, there's something for every member of your family.

### CENTRAL PARK



#### Active Zone

-  Children's playground
-  Play Lawn



#### Social Zone

-  Stone Garden
-  Bench Area

#### Tranquil Zone

-  Walking Trail
-  Meditation Lawn

### POOL CLUB

-  Clubhouse
-  Swimming pools
-  Gazebo

### OTHER AMENITIES AND PROJECT FEATURES

-  Basketball court
-  Commercial strip
-  Rotunda and Water feature
-  Gated Community







### A Picture of Relaxation

Find balance in your every day life and take time to relax whether on your own or with your family at Park Residences' unique new amenities.





### *A Picture of Happiness*

Go have some fun and spend quality time with the kids. Our children's playground will surely put a smile on your child's face.





### A Picture of Leisure

Our cool swimming pool is perfect for both active and laid-back lifestyles. Whether you're looking to get a tan or swim a few laps, every day is a nice day to be out in the sun.





### A Picture of Wellness

Our walking trail and meditation lawn are perfect for outdoor exercises like yoga, running, biking, and other activities for your overall wellness.





### A Picture of Splendor

Take a few seconds to admire the magnificence of modern life in Park Residences' at our elegant, voguish lounge.





### *A Picture of Comfort*

All residential units are specially designed to put your mind and body at ease. Enjoy the comfort of home at Park Residences.





Dressed-Up Unit, Stock Photo

### A Picture of Distinction

Find a unit that fits your personality. Take a look at our fully-dressed model units and handpick the perfect home for you

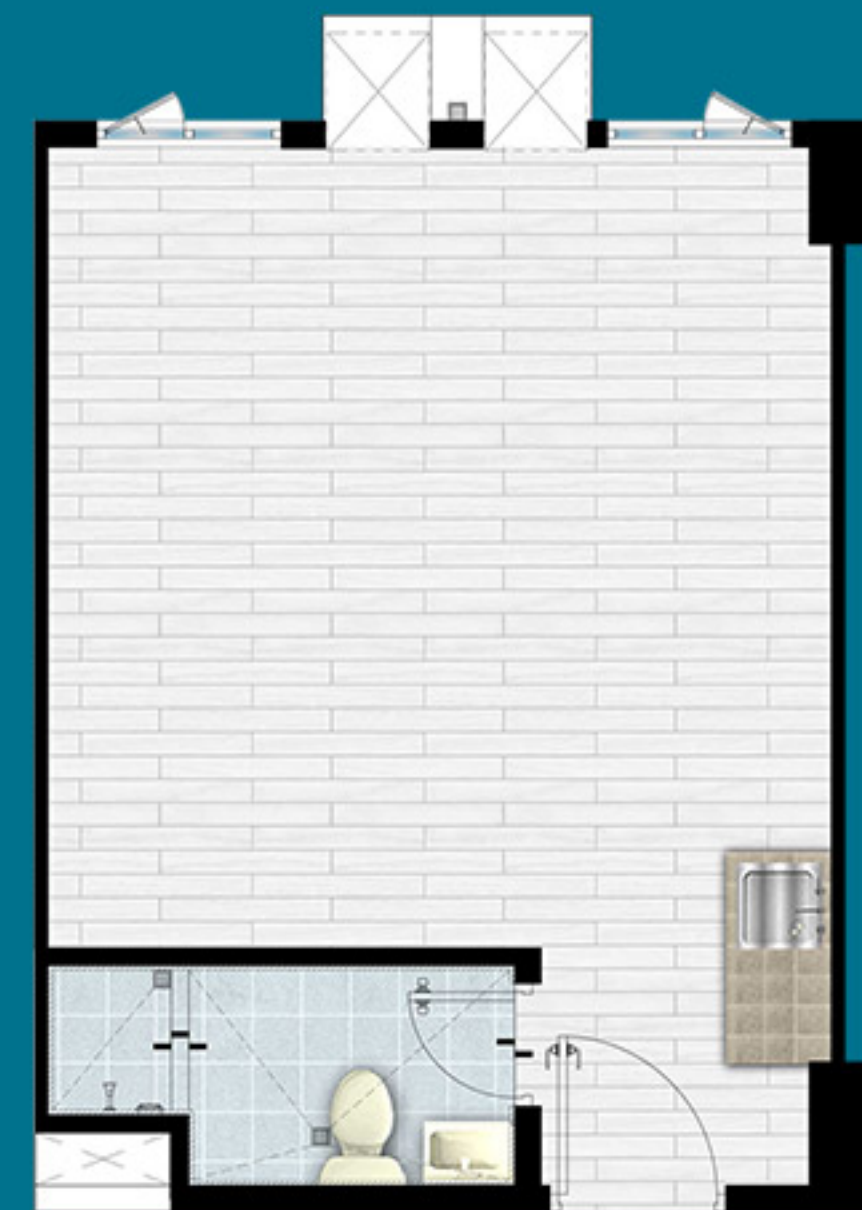

DELIVERABLE  
FLEXI SUITE  
UNIT  
± 28.52sqm

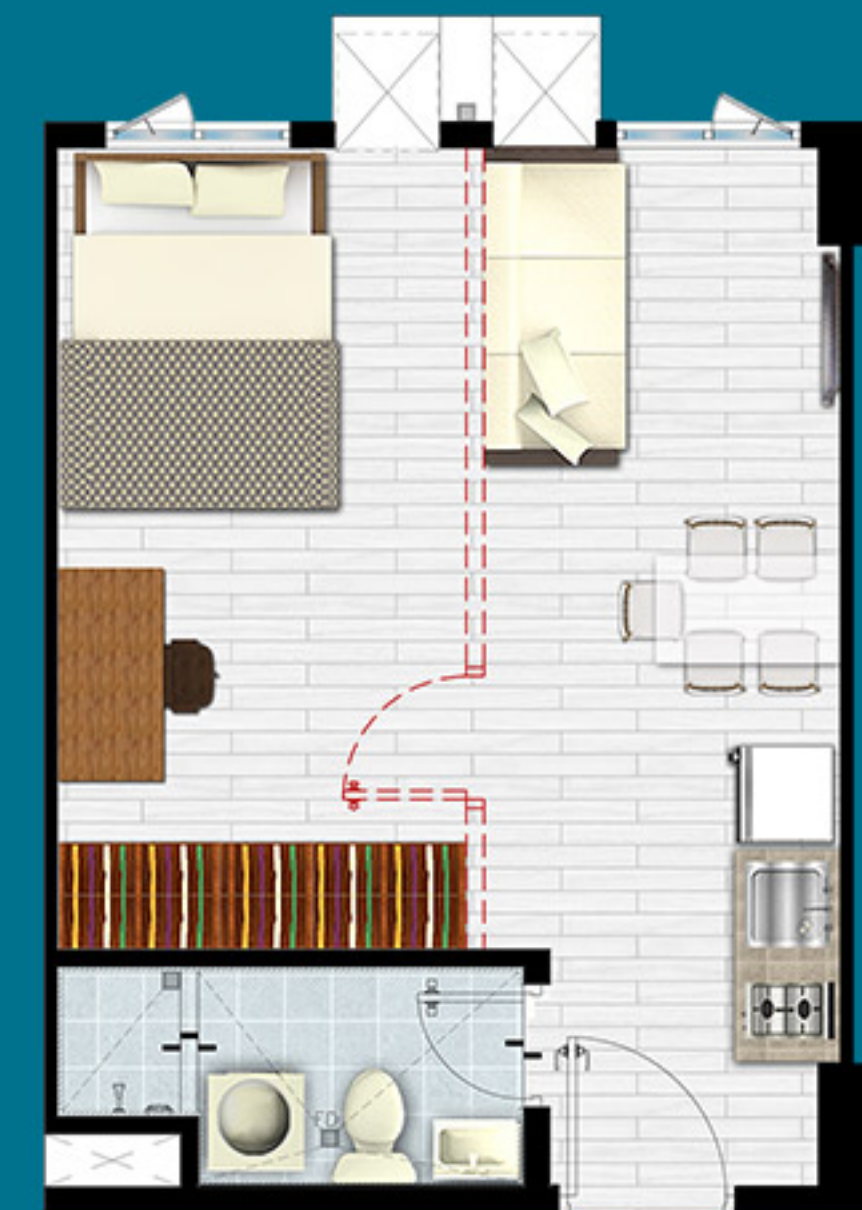

1 BEDROOM  
FLEXI SUITE UNIT  
(Suggested furniture layout)  
± 28.52sqm



STUDIO FLEXI  
SUITE UNIT  
(Suggested furniture layout)  
± 28.52sqm



2 BEDROOM  
FLEXI SUITE UNIT  
(Suggested furniture layout)  
± 28.52sqm





**A Picture of Excellence**

Rest-assured that our accommodating and hardworking management staff will always be there to take care of your property investment and lend you a helping hand.









### *A Picture of Trust*

The same way we entrust you with the keys to your new home, you can rest assured that our hardworking management staff will cater to your every need and provide you a picture perfect life at Park Residences.



# SMDC

    The Official SMDC  
[www.smdc.com](http://www.smdc.com)

HLURB LS No. 033875 (Ph1); 034389 (Ph2)  
HLURB AA-STR-071919-0211  
Brgy. Tagapo, Sta. Rosa City, Laguna  
Completion Date: December 31, 2021 (Ph 1);  
June 30, 2023 (Ph2)  
Developer: Vancouver Lands, Inc.